

ROBUST: 功率强劲, “品”如其名,

功率强劲而结构紧凑。由于隔音效果非常好, ROBUST 在运行过程中噪音非常低。它可以被集成在工装设备任意方向的位置, 即使在恶劣的工况条件中连续使用也不会被损坏。

高压鼓风机

ROBUST

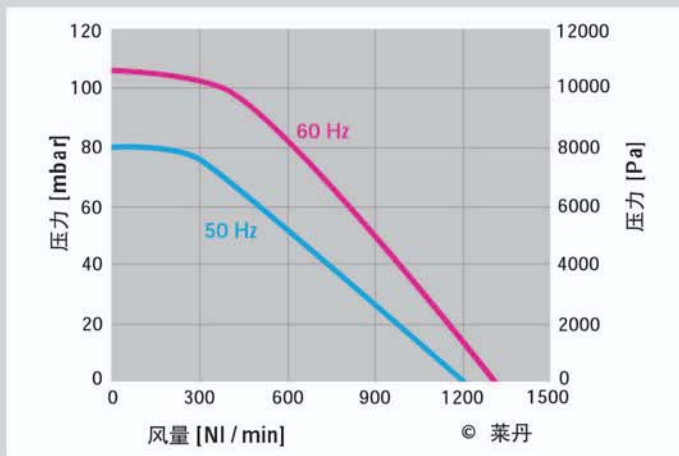

技术参数

旋涡式鼓风机

参数	单位	50	60
频率	Hz	50	60
空气流量 (20 °C)	l/min	1200	1300
静态压力	Pa	8000	10500
最高环境温度	°C	60	60
噪音值	LpA (dB)	62	62
环境保护执行标准	(IEC 60529)	IP 54	IP 54
进风口外径	mm	∅ 38	∅ 38
出风口外径	mm	∅ 38	∅ 38
重量	kg	8.0	8.0
认证标识		CE	CE
保护等级 I		⊕	⊕

安装尺寸, 单位: mm

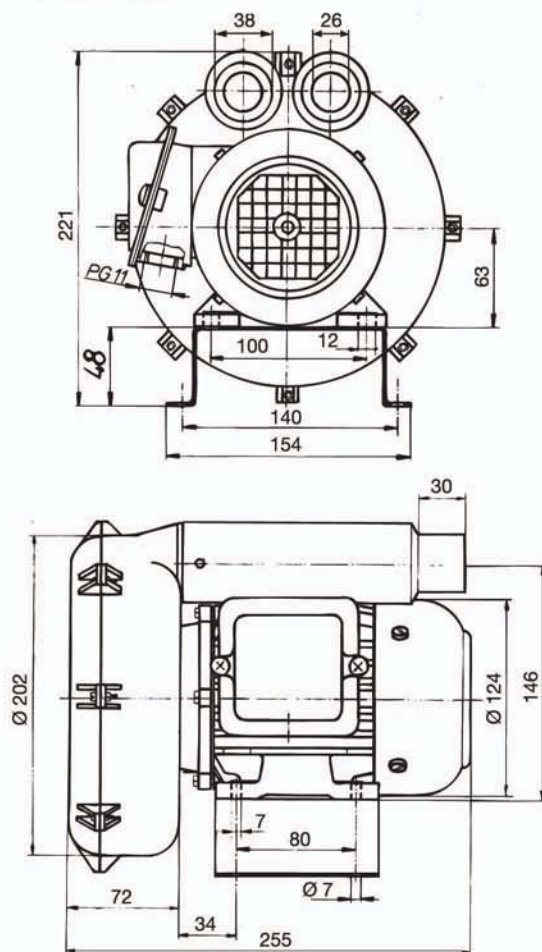

电压	V~ 50Hz	1 × 120	1 × 230	3 × 230 / 400	3 × 500
	60Hz			3 × 440 - 480	
功率	W	250	250	250	250
无电源线	订货号	103.434		103.429	103.435
3米电源线/欧标插头	订货号		103.432		

根据客户要求可提供特殊规格的产品

高压鼓风机 ROBUST 适用附件 (Φ38mm)

107.350		PVC 风管, Φ19mm
107.290		Φ19mm 风管卡箍
107.242		Φ19mm 盖帽, 风分配管适用, (风分配管型号: 107.298)
107.354		不锈钢过滤网, 直插式 安装在鼓风机进风口处
108.623 104.017		风机马达电容器 230V 风机马达电容器 120V
107.298		风分配管, 和鼓风机 ROBUST 出风口与风分配管 107.293 为直插式连接
107.286		PVC 风管, Φ38mm
107.287		Φ38mm, Φ60mm 风管卡箍
107.241		Φ38mm 盖帽, 和风分配管为 直插式连接, (风分配管型号: 107.292, 107.293)
107.293		风分配管, 和风分配管 1107.292 配合使用, 直插式连接

风量调节装置及开关

108.755		风量手动调节装置及开关 尺寸: 214 × 88 × 133mm
107.299		风量装置开关 在需要时中断为加热器送风 (气压 5 bar) 尺寸: 214 × 88 × 133mm
		适用于 LHS20, LHS40, ROBUST

根据客户要求可提供特殊风嘴

如果使用非莱丹公司鼓风机, 压缩机或附件,
则莱丹公司不予提供保修。

LEISTER

PROCESS HEAT

NEW

**Frequency converter
for Leister blowers.**

**More power,
variable air volume,
controllable via
remote control.**

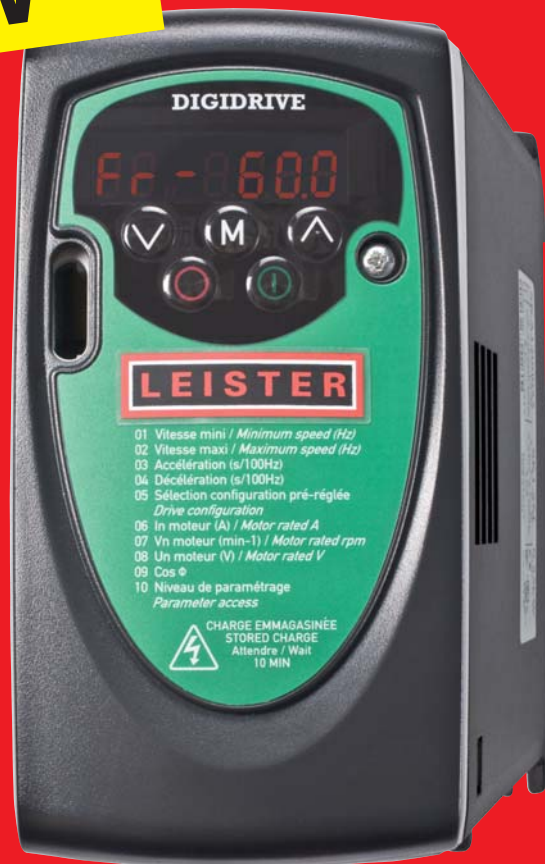

SILENCE

ROBUST



ASO



Benefit of frequency converter with Leister blowers

- Better hot air processes** Because air volume and heating performance can be set independently, precisely and reproducibly from each other.
- Up to 60% higher blower performance** Because the frequency converter lets the blower turn faster than the mains frequency (see diagram below).
- Lower system costs** Smaller and cheaper blowers can be used or fewer blowers will be necessary, because multiple air heaters can be connected to a blower.
- Easy to integrate in the controller** By the remote control interface 4-20mA/0-10V or by fixed set values (up to 4) via clamp contacts.
- Air supply controller** Active braking function enables quick air volume changes, i.e. for timed systems.
- Save energy – heat only when necessary** There are timed processes, where hot air is necessary within a clearly defined time window. For the rest of the time, the air volume can be minimised and the heating performance switched off.
- Simple plug & play installation** The frequency converter is already configured for operation with Leister blowers.
- Secure** Integrated current monitoring and a built-in motor protection switch protect the blower.
- Elimination of the motor condensator** This function is already integrated in the frequency converter.

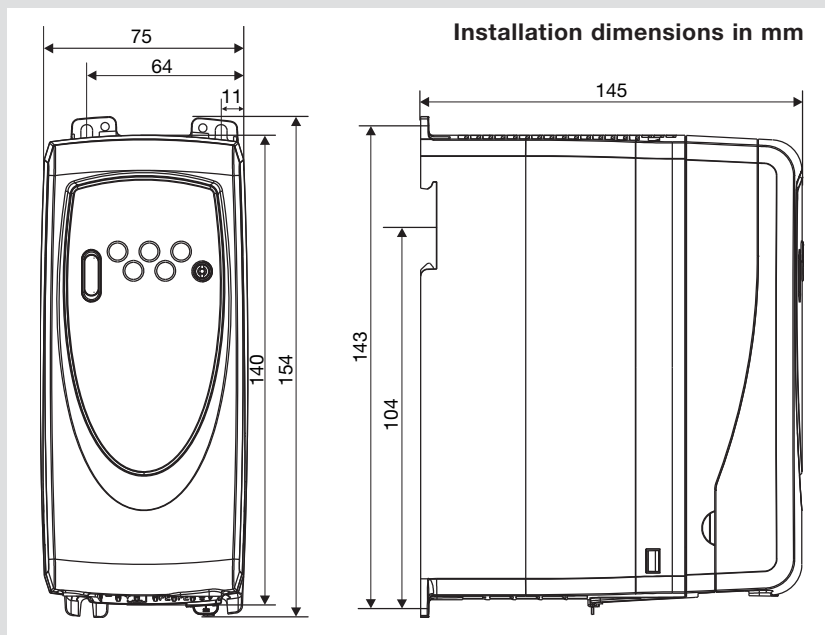
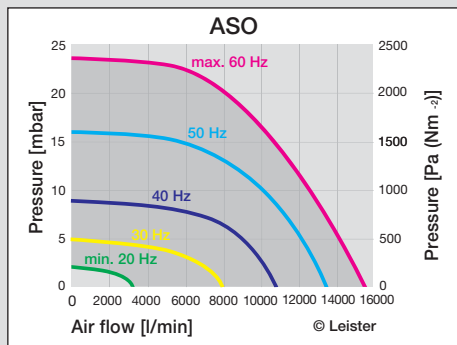
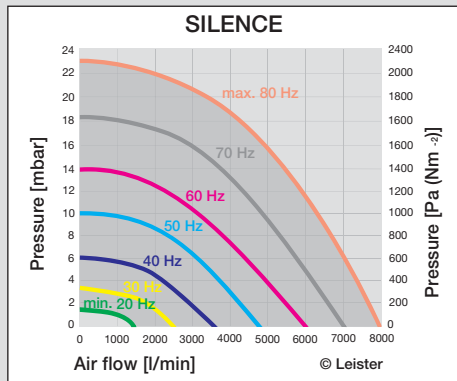
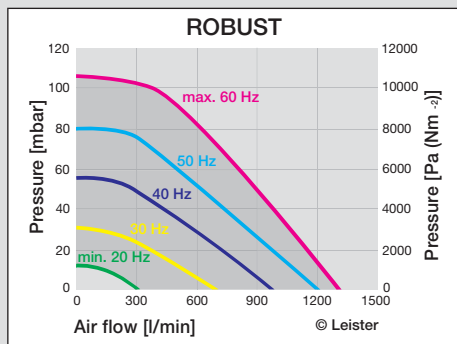

Technical Data

Input voltage	V~	1 x 200 – 240 VAC
Max. blower rated power	W	550
Frequency	Hz	50 / 60
Typical input current at full load	A	8.1
Output rated power (100%)	A	3.0
Weight	kg	1.0
Mark of conformity		CE UL
Protection classe I		⊕

Article No. 117.359 frequency converter FC 550

Flyer FC 550 / ENG / 02.2008

© Copyright by Leister



Headquarters:

Leister Process Technologies
Galileostrasse 10
6056 Kaegiswil / Switzerland

phone: +41 41 662 74 74
fax: +41 41 662 74 16
leister@leister.com

www.leister.com